

ART-29411 BALL BEARINGS

FOR THE REPLACEMENT OF JOURNAL BUSHINGS IN ARISTO-CRAFT FREIGHT AND PASSENGER CAR TRUCKS

The ART-29411 Ball Bearings are designed to replace the existing journal bushings in Aristo-Craft freight car and passenger car trucks. Some minor modifications to truck journals and axle ends may be necessary for proper function of ball bearings. Depending on conditions, disassembly of truck may be required to replace the existing axle journal bushings with the ball bearings.

Step 1) Remove trucks from car. Most trucks are connected to the car at the bolsters with a philips head screw. If car has electrical pickup, the un-soldering of electrical pickup leads may be necessary.

Step 2) Remove wheelsets (Axles) from trucks.

Step 3) Remove journal bushings (C) from truck journal. The journal bushing will no longer be needed.

Step 4) Install the ball bearing (A) into truck journal (B). The collar of the ball bearing should be to the outside of the truck journal. At this time it may be necessary to enlarge the journal hole in the side frame. The journal hole in the side frame needs to be .226" (5.8-6.0 mm) in diameter for the ball bearing to fit properly.

If the truck has electrical pickups, the electrical pickup "wire eye tab" (D) needs to be modified for the installation of the ball bearing. The loop in the wire eye tab needs to be enlarged to the same dimensions as the journal hole. Then placed between the ball bearing and the truck journal in the same fashion that it was with the journal bushing.

Step 5) Replace wheelsets (axles) in the trucks. If truck was disassembled, it needs to be reassembled at this time.

The axle end may require sanding or filing to slightly reduce the outside diameter of the axle end to fit into the ball bearing. Sanding the axle end with 220 grit sand paper should sufficient-ly reduce the outside diameter of the axle end.

Step 6) Replace trucks on the car. Mount the trucks to the car the same way they were installed before removal. Re-solder any solder connections that were un-soldered.

At this point your car should be ready to return to service complete with its new ball bearings. Enjoy!

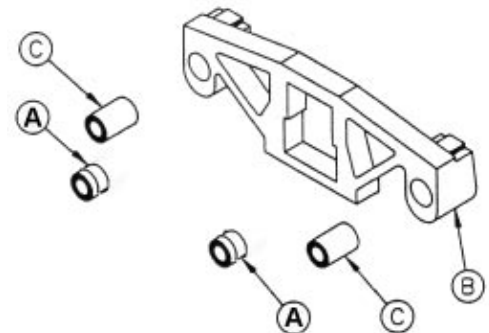

*Example of ART-29101 freight truck application or trucks without electrical pick up. Other freight trucks may differ

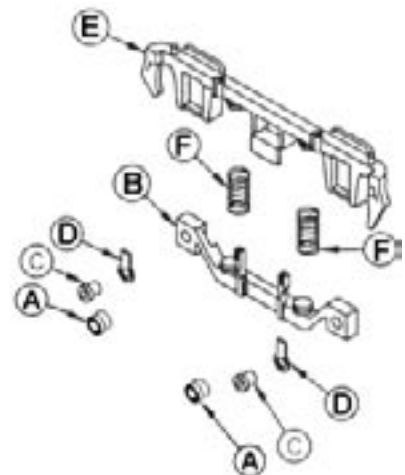

*Example of ART-29109 passenger truck application or trucks with electrical pick up. Other passenger trucks may differ.

A: Ball Bearing

B: Truck Journal (typically part of side frame or spring holder)

C: Journal (Axle) Bushing

D: Wire Eye Tab (For electrical pickups)

E, F: Other parts of truck. Shown for reference.

*For ease of installation, only important parts of trucks shown for ball bearing installation. Refer to exploded parts diagrams for complete drawings of trucks.