

#1 Gauge 1:29 SCALE

# 41400 SERIES 100 TON HOPPER CAR

## EXPLODED PARTS DIAGRAM

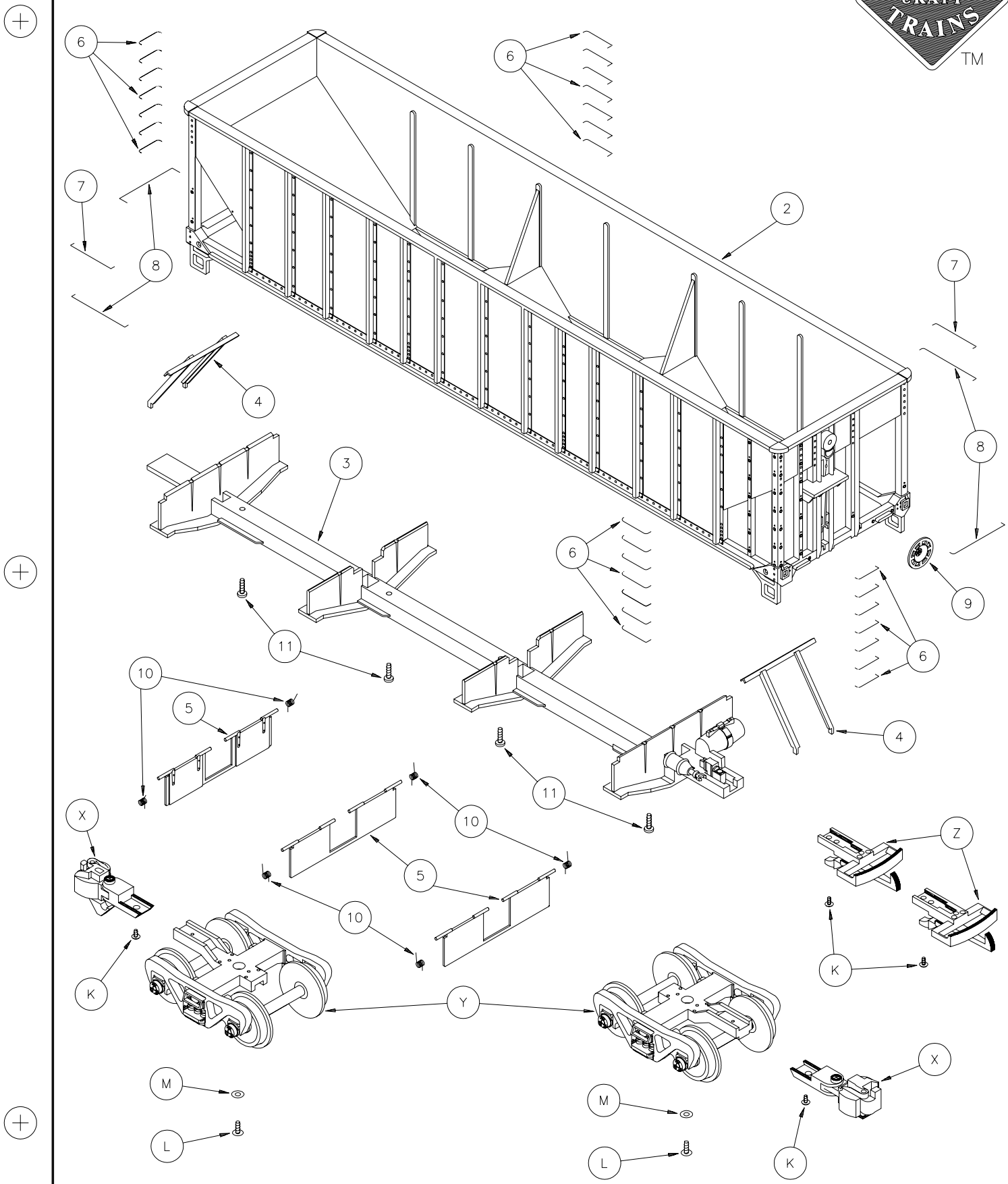

# 41400 SERIES 100 TON HOPPER CAR

## PARTS LIST-ORDER FORM



SPECIFY ROADNAME/ART#: \_\_\_\_\_ Insert Quantity Ordered

Part #	Description *	Price	Quantity Ordered
① 41400-01	Instruction Manual	\$ 1.00	
② 414XX-02	Body	15.00	
③ 414XX-03	Underframe	10.00	
④ 414XX-04	Body End Support	.50	
⑤ 414XX-05	Outlet Doors	10.00	
⑥ 414XX-06	Grab Iron Short	2.00	
⑦ 414XX-07	Grab Iron Medium	1.00	
⑧ 414XX-08	Grab Iron Long	1.00	
⑨ 414XX-09	Brake Wheel	.50	
⑩ 41400-10	Door Spring	.50	
⑪ 41400-11	Underframe Screw	.50	
Ⓐ	Blackened Steel Wheel/Axle Assy.	.50	
Ⓑ	Sideframe	1.00	
Ⓒ	Axle Bushing	1.00	
Ⓓ	Brakeshoes	1.00	
Ⓔ	Spring Retainer Place	2.00	
Ⓕ	Axle End Cap	1.00	
Ⓖ	Truck Spring	1.00	
Ⓗ	Bolster	1.00	
Ⓙ	Spring Retainer Plate Screw	1.00	
Ⓚ	Mounting Screw	1.00	
Ⓛ	Bolster Screw	1.00	
Ⓜ	Bolster Washer	1.00	
Ⓝ	Coupler	1.00	
Ⓟ	Roller Bearing Truck w/o Wheelsets	1.00	
Ⓡ	Roller Bearing Truck w/Wheelsets	1.00	
Ⓢ	Plastic Loop/Hook Coupler (2 pcs.)	No Charge	
Ⓣ	41400-99	Parts List-Order Form	No Charge

RETURN THIS FORM WITH YOUR ORDER  
A REPLACEMENT FORM WILL BE SENT WITH YOUR ORDER

NOTE: When ordering replacement parts or repair request, please refer to proper 5 or 7 digit number listed. XX refers to last two digits of roadname ART freight car number when part is painted to match, i.e. ART-41401 B & O. 41401-02 would then refer to BODY for B & O 100 TON HOPPER CARS ART-41401. If part is same FOR ALL 100 TON HOPPER CARS, 41400-plus 2 digit number would be used to denote specific part, i.e. 41400-11 Underframe Screw used on ALL 100 TON HOPPER CARS regardless of railroad name. When part is same FOR ALL 100 TON HOPPER CARS AND OTHER FREIGHT CARS, 29200 (or other #-plus 2 digit number) would be used to denote specific part regardless of roadname/car type. Please specify roadname/ART# on line above part# list and always when ordering parts by phone/fax/letter. Unpainted/painted part(s) will be substituted if the painted to match part(s) ordered are not available. In addition to Price Each shown please enclose... \$3.50 shipping/handling if part order is less than \$10.00 or \$5.00 shipping/handling if part order is \$10.00 or more. This is for part order only. Not WARRANTY order.

Include proper payment for parts plus shipping/handling with your (USA Bank Account Only) check/money order payable in US Dollars (\$) to: Polk's Hobbies. Please DO NOT SEND CASH. Sorry no C.O.D.'s for parts. New Jersey residents add 6% NJ State Sales Tax. Be Sure to include your name, street address (no Post Office Box please), city, state (or province), country (if outside USA), and postal zip code, along with daytime phone number including Area Code, so that you may be contacted if necessary.

Mail order form and payment to:  
ARISTO-CRAFT TRAINS/Polk's Modelcraft Hobbies, Inc.  
698 South 21st Street  
Irvington, NJ 07111-4109 USA  
Allow 4-6 weeks for processing and delivery.

PLEASE PRINT CLEARLY  
NAME: \_\_\_\_\_  
ADDRESS \_\_\_\_\_  
CITY: \_\_\_\_\_ STATE: \_\_\_\_\_ ZIP \_\_\_\_\_  
PHONE: (\_\_\_\_\_) - \_\_\_\_\_

\* one piece unless otherwise noted

